

Floor Plan

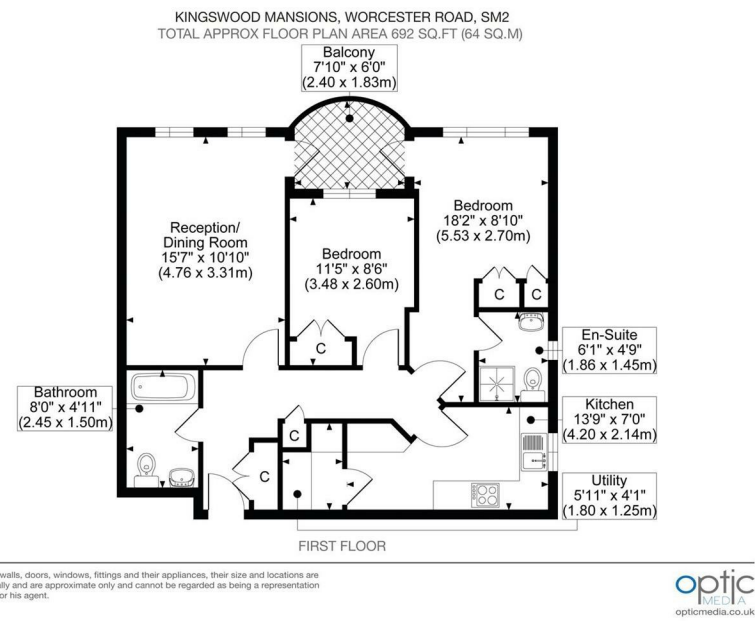

For illustration purposes only



All dimensions and measurements are approximate and for guidance only.

Just Centro's Opinion...

A beautifully presented two-bedroom first-floor apartment forming part of an attractive modern development of just 12 apartments on Worcester Road, Sutton (SM2).

Recently redecorated throughout and benefiting from brand-new carpets, this spacious apartment offers well-proportioned accommodation ideal for professionals, couples, or small families.

The property features a generous living room with direct access to a private balcony, providing an excellent space for relaxing or entertaining. The modern fitted kitchen includes a breakfast bar, dishwasher, and ample storage, while a separate utility room offers additional practicality.

The principal bedroom is a spacious double with fitted wardrobes, access to the balcony, and the benefit of an en-suite shower room. The second bedroom is also a good-sized double and includes fitted wardrobes. A contemporary family bathroom completes the accommodation.

Further benefits include gated allocated parking and a highly convenient location within walking distance of both Cheam and Sutton railway stations, offering excellent transport links into Central London.

Early viewing is highly recommended.

Additional Photos

