

Location

Location Map



Important Note

Centro Residential Sales and Lettings limited have not tested any services, heating system, electrical system, appliances, fixtures and fittings, that may be included in this property and would advise interested parties to satisfy themselves as to their condition or investigating the presence of any deleterious materials.

Viewing: Strictly by appointment through:

CENTRO RESIDENTIAL SALES AND LETTINGS LIMITED

Tel: 020 8401 5000

E-mail: residential@centro.plc.uk

See a selection of our properties at www.centro.plc.uk

£1,950 Per Month -
Cheam Road, Sutton, SM2 7LQ



Description

- New Development
- Two Bedrooms
- Two Bathrooms
- Top Floor
- Private Terrace
- Impeccable Finish
- Gated Parking
- Fitted Kitchen
- Council Tax Band : D
- EPC Rating : B

Features

- New Build
- Double Glazing
- Neutral Décor

What you need to know

- Term: 12 months
- Rent: £1950pcm exclusive of bills
- Security deposit: £2250
- Council Tax Band D
- Energy Rating: B



Accommodation

Additional Photo



All dimensions and measurements are approximate and for guidance only.

Just Centro's Opinion...

A stunning newly built two-bedroom, two bathroom apartment finished to a impeccable standard throughout located along Cheam Road, which is set between Cheam Village, Ewell and Banstead.

This stunning top floor apartment boasts a large living area with access to a private terrace, fitted kitchen with Neff appliances, large master bedroom with built in wardrobes and en suite shower room, a second double bedroom and a family bathroom.

Additional Benefits include gated parking, video entry system, bike storage, additional communal grounds and a high end finish throughout.

Offered unfurnished and available to view now.

EPC Graph

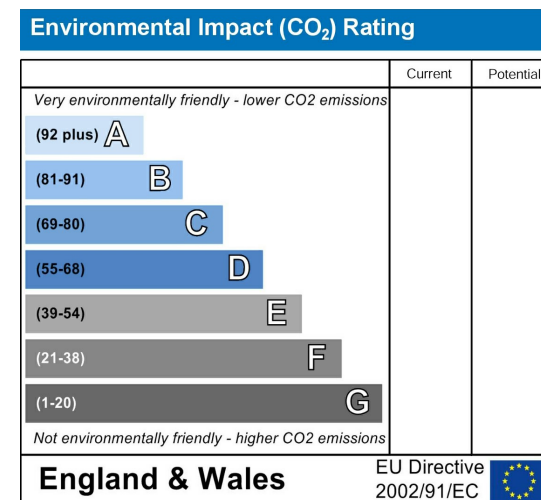
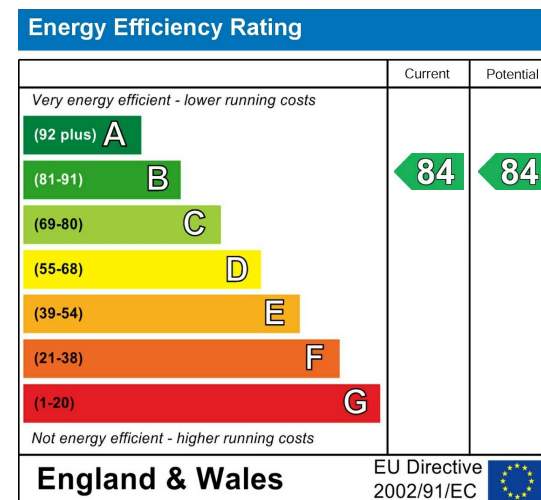

Floor Plan

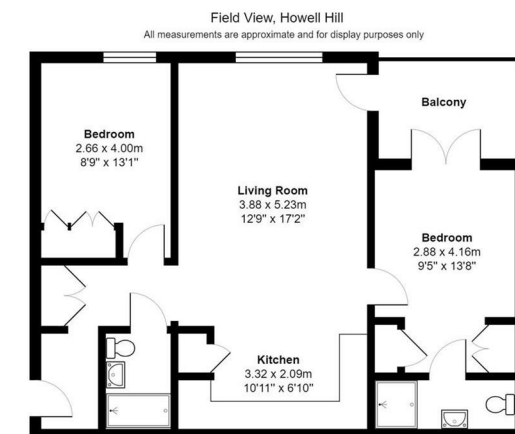

For illustration purposes only