

Floor plan produced in accordance with RICS Property Measurement Standards incorporating International Property Measurement Standards (IPMS2 Residential). © ncthecsm 2023. RICS Certified Property Measurer REF: 511197

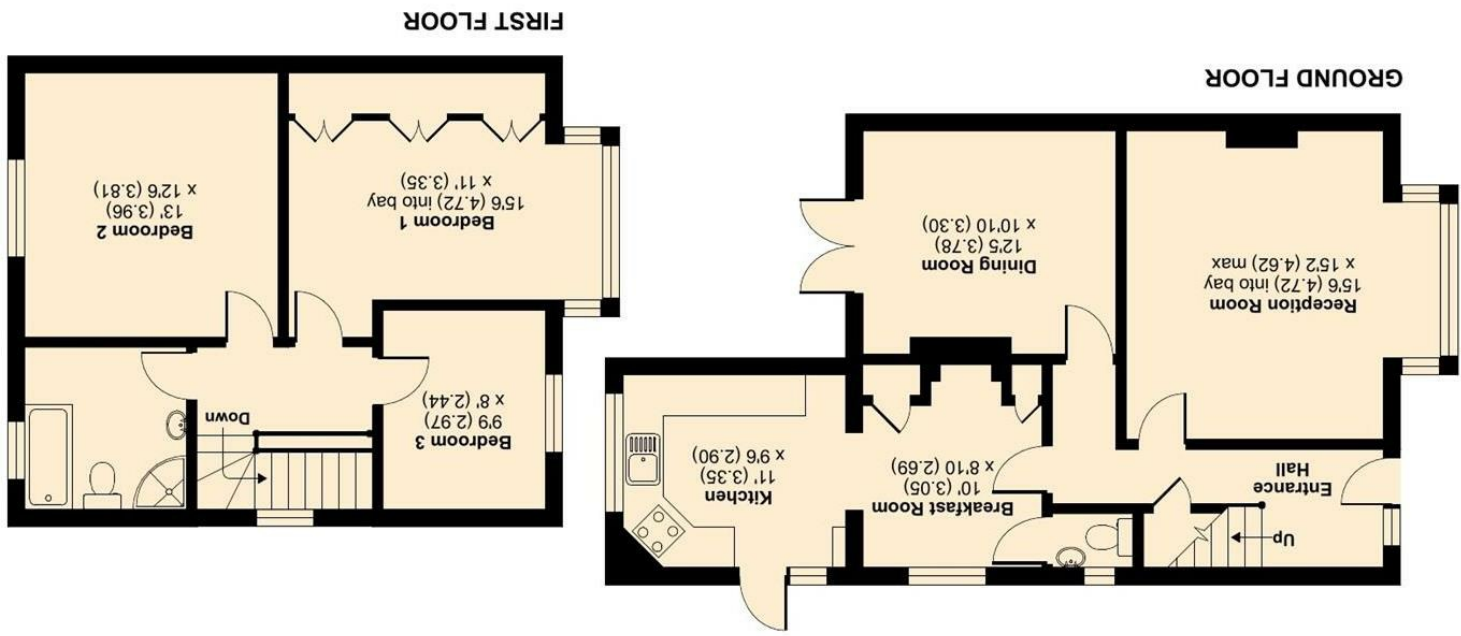

Cotswold Road, Sutton, SM2  
Approximate Area = 1256 sq ft / 116.7 sq m  
For identification only - Not to scale



**\*\* CHAIN FREE \*\***

A FANTASTIC OPPORTUNITY TO PURCHASE A WONDERFUL 3 BEDROOM DETACHED FAMILY HOME LOCATED JUST 0.2 MILES FROM BELMONT TRAIN STATION, OFFERING A HOST OF SERVICES INCLUDING A DIRECT TRAIN TO LONDON VICTORIA. BELMONT ALSO BOASTS A RANGE OF LOCAL SHOPS AND RESTAURANTS.

THE PROPERTY BENEFITS FROM 2 RECEPTION ROOMS ALONG WITH A SEPARATE BREAKFAST ROOM LEADING TO THE KITCHEN. UPSTAIRS YOU ARE PRESENTED WITH 3 SPACIOUS BEDROOMS AND A BATHROOM.

WITH LOCAL SCHOOLS SUCH AS THE AVENUE PRIMARY SCHOOL, SEATON HOUSE, OVERTON GRANGE AND THE HARRIS ACADEMY ALL WITHIN A SHORT DISTANCE OF THE PROPERTY, WHAT MORE COULD YOU ASK FOR?

THE PROPERTY ALSO BENEFITS FROM OFF STREET PARKING.

IF YOU ARE LOOKING FOR THE PERFECT FAMILY HOME CALL US TODAY ON 020 8643 7777.

- OFF STREET PARKING
- DETACHED HOUSE
- CLOSE TO LOCAL AMENITIES
- COUNCIL TAX BAND F
- EPC RATING D

