

## Location

### Location Map

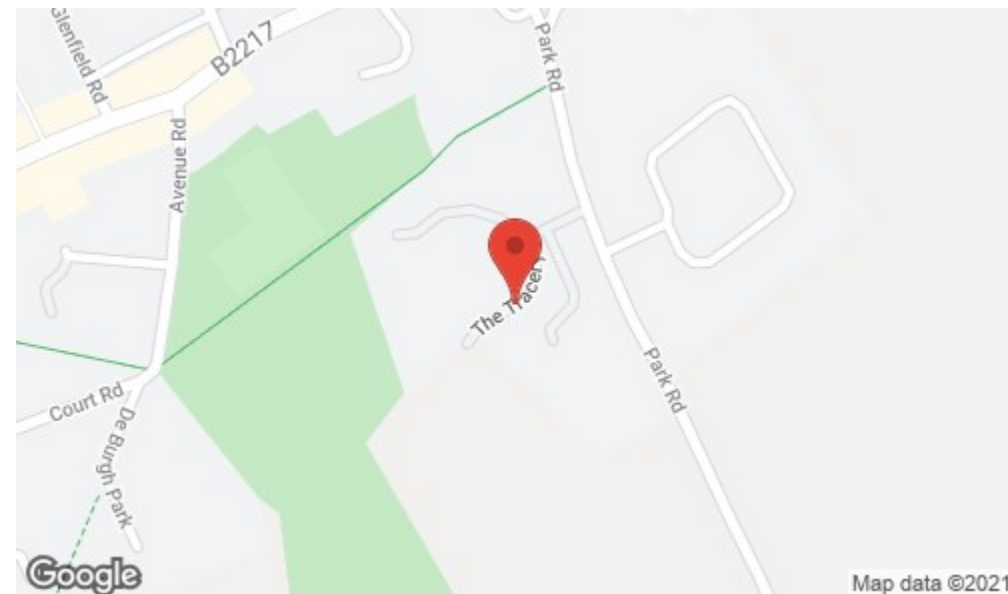

### Important Note

Centro Residential Sales and Lettings limited have not tested any services, heating system, electrical system, appliances, fixtures and fittings, that may be included in this property and would advise interested parties to satisfy themselves as to their condition or investigating the presence of any deleterious materials.

Viewing: Strictly by appointment through:

**CENTRO RESIDENTIAL SALES AND LETTINGS LIMITED**

Tel: 020 8401 5000

E-mail: [residential@centro.plc.uk](mailto:residential@centro.plc.uk)

See a selection of our properties at [www.centro.plc.uk](http://www.centro.plc.uk)

## £1,600 Per Month -

The Tracery, Banstead, Surrey SM7 3DD



### Description

- Modern Development
- Ground Floor
- Three Bedrooms
- Two Bathroom
- Patio Area
- Allocated Parking



### Features

- Gas Central Heating
- Double Glazing
- Patio Area

### What you need to know

- Term: 12 months
- Rent: £1600pcm exclusive of bills
- Security deposit: £1846.00
- Council Tax Band E
- Energy Rating: C

Accommodation

Additional Photo



All dimensions and measurements are approximate and for guidance only.

*Just Centro's Opinion...*

An immaculately presented three double bedrooms, two bathroom apartment set within a modern development only a short walk away from Banstead Village. This stunning ground floor apartment boasts a spacious lounge leading to a private patio area and communal gardens, a fully fitted kitchen, a large master bedroom with en-suite shower room and fitted wardrobes, a further two double bedrooms with a fitted wardrobe and a separate family bathroom with bath and walk-in shower.

Added benefits include allocated and visitors Parking, video-entry system, a storage room, neutral décor, gas central heating and double glazing throughout.

Offered unfurnished and available in July. Viewings are highly recommended.

EPC Graph

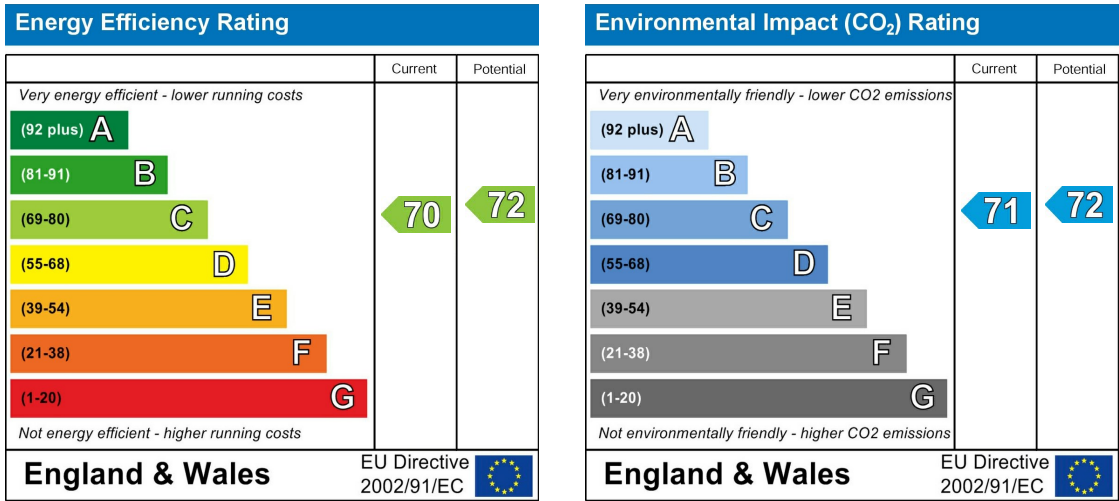

Floor Plan

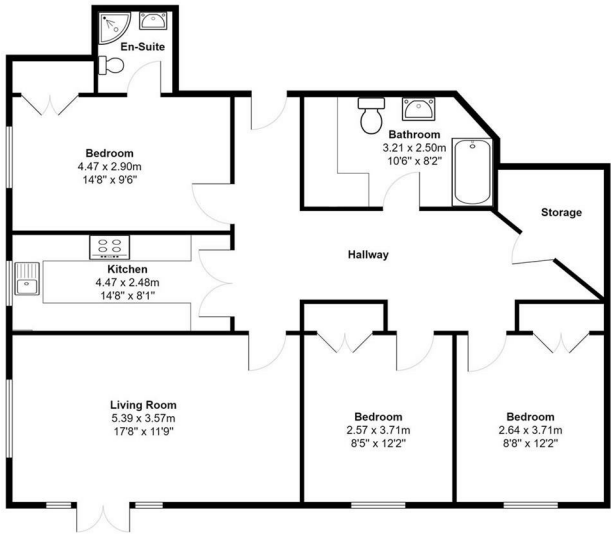

For illustration purposes only